

Medium Painting Skills Board Build Plans

- This simple training board uses **standard casing** and **baseboard** on a 4' x 4' drywall surface to simulate conditions where prep work and paint are needed
- **Spackling, sanding, caulking, taping and masking, brushing, and mini rollers** can be used for skills practice on this board
- As shown, the board is made from a half of a 4x8 sheet of 1/2" OSB and drywall

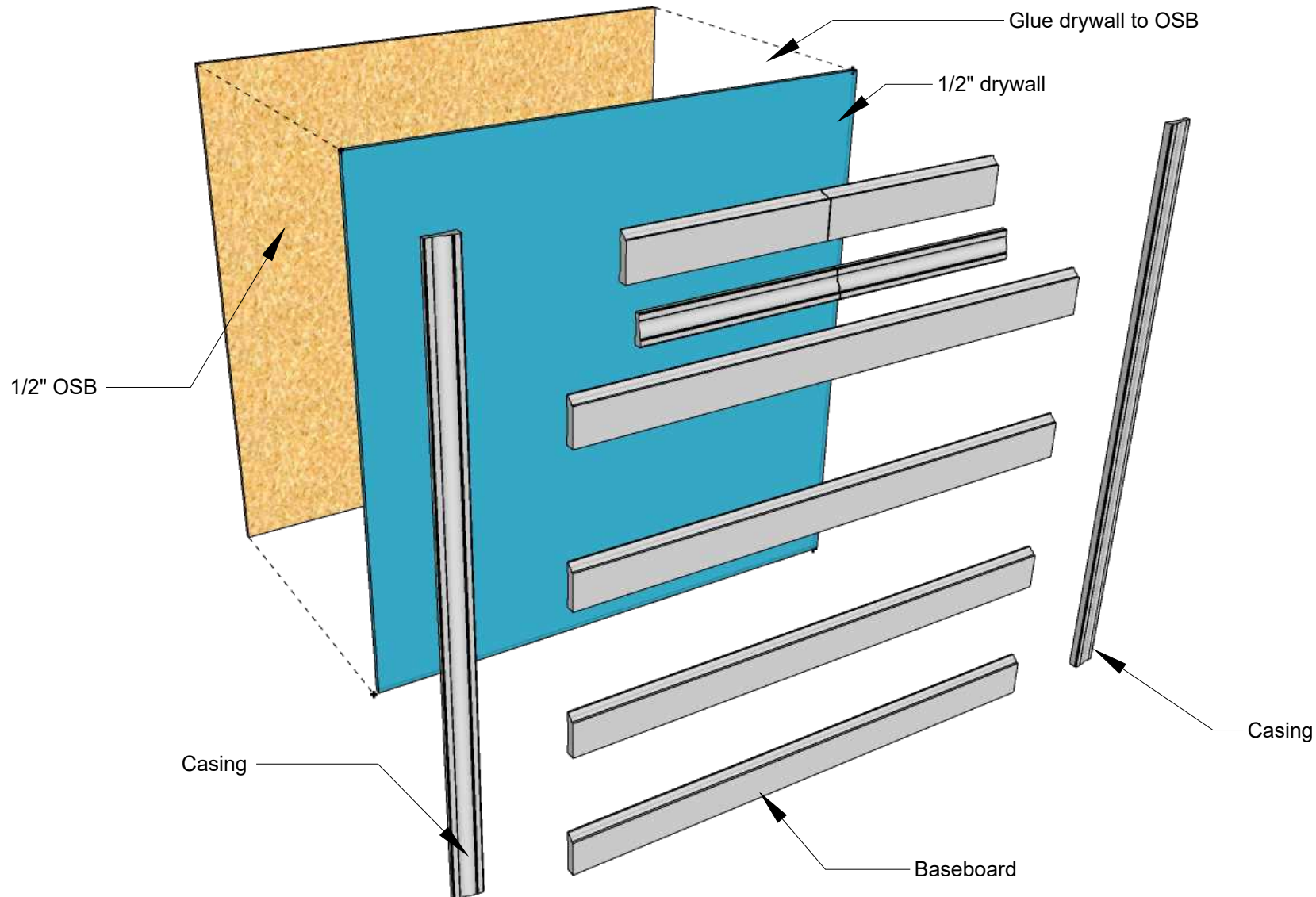

Medium Painting Skills Board Build Plans

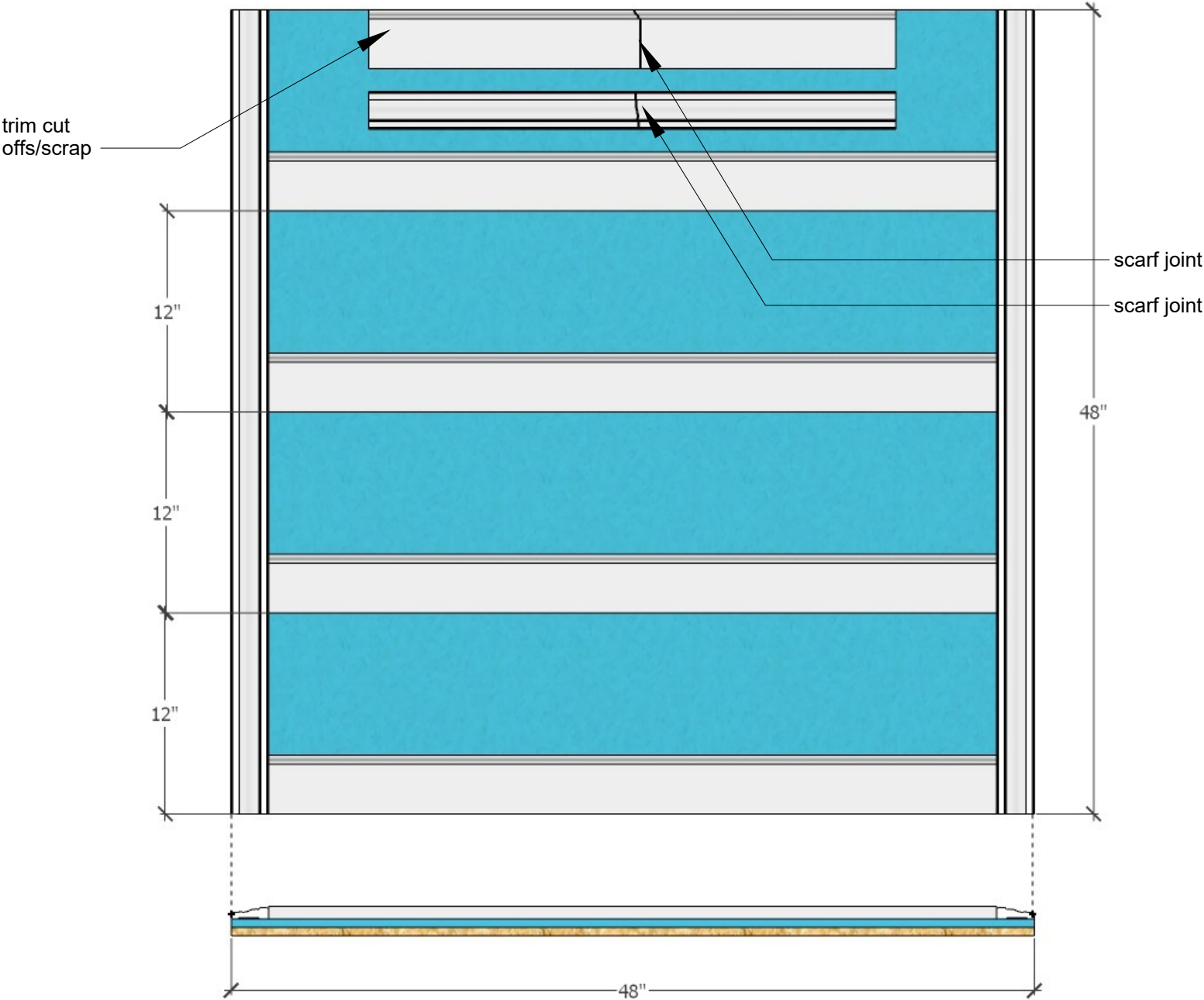

Painter Skills
Program

DESCRIPTION
Paint Skills
Board Plans

Designed by:
Joseph
Carswell
4/4/2024

PNT
bld

Medium Painting Skills Board Build Notes

- The 48" x 48" drywall and OSB panels should be lightly glued together with adhesive during assembly
- The trim boards should be nailed on using 16 or 18 gauge nails for opportunity to spackle the holes
- 15 gauge nails leave too large of a hole and are not realistic
- Nails should be less than 1 1/2" to prevent the ends from protruding out of the back of the board – no shorter than 1 ¼ for a decent hold
- Trim should not always meet perfectly to provide opportunity for repairs – engineer realistic gaps at butts and miters for prep practice
- The pieces mounted to the top of the board are cutoffs or scrap leftover from the build and are tacked on here to serve as initial practice area for various skills. These can be any size but should include seams and joints for caulking



DESCRIPTION
Paint Skills
Board Plans

Designed by:
Joseph
Carswell
4/4/2024

PNT
bld